

GLAZING DETAIL ON CHANNEL

(SCALE 1:1 (A4))

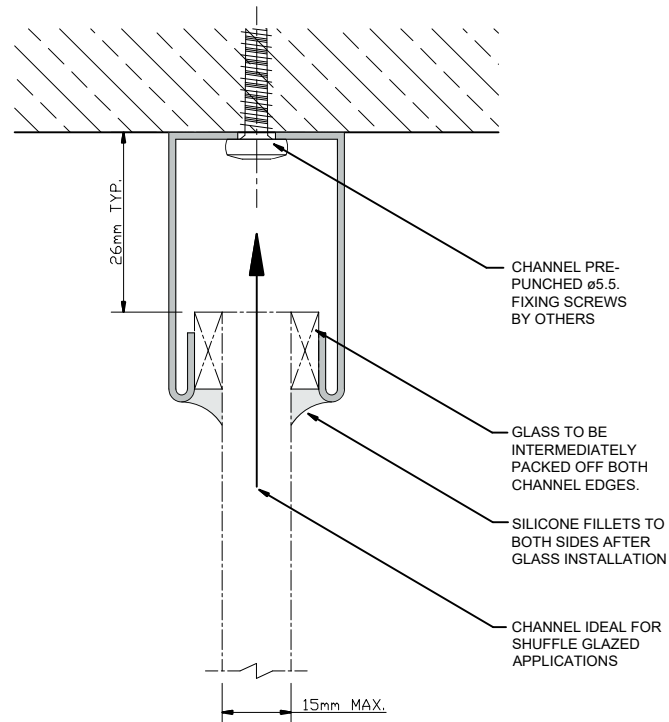

EXAMPLE FINISHING DETAILS

(SCALE 1:5 (A4))

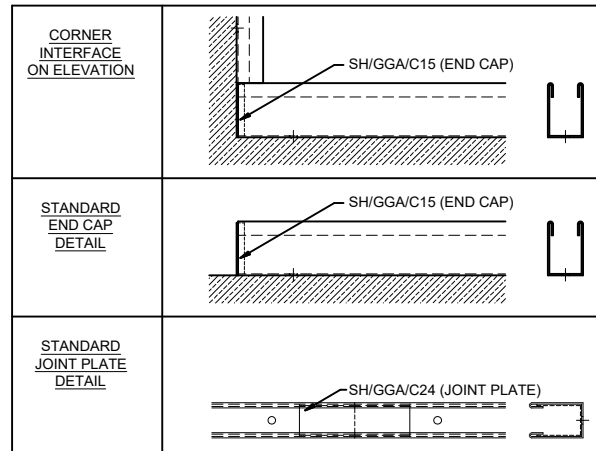

NOTES/SPECIFICATION:

GLAZING CHANNEL SUPPLIED IN 316 STAINLESS STEEL:-

POLISHED FINISH

GLAZING CHANNEL SUITABLE FOR 15 mm MAX GLASS PANES

NOTE: CUSTOMER TO PROVIDE REQUIRED FIXINGS. PACKERS ARE SUPPLIED WITH THE CHANNELS AS STANDARD.

PRODUCT ELEVATIONS

(SCALE 1:2 (A4))

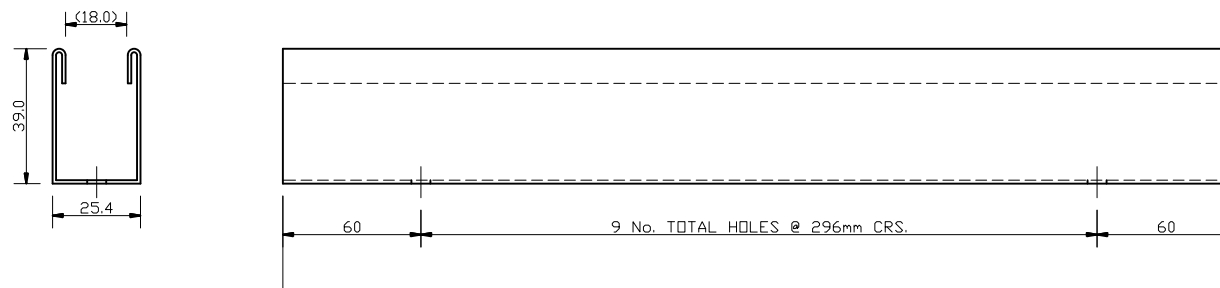

NOTE - COMPONENT TO BE CUT DOWN ON SITE TO SUIT DIMENSIONAL REQUIREMENTS

| | |
|---------------------|--|
| PRODUCT REF: | SH/GGA/C13 |
| DESCRIPTION: | DIMENSIONED ELEVATIONS AND PRODUCT DETAILS |
| DRAWING REF: | SH/GGA/C13 - 001 |